

IMPORTANT INFORMATION ABOUT  
BAL TIC INFLATABLE  
LIFEJACKETS

**BAL TIC**<sup>®</sup>  
LIFEJACKETS SWEDEN



# HOW THEY OPERATE

Inflatable lifejackets have an inflation valve either automatic or manual connected to an airtight bladder. To operate the manual valve you simply pull the toggle on the right hand side of the jacket downwards with a jerk and the bladder will start to inflate immediately. The automatic lifejacket will operate and inflate once it has been immersed in water for three seconds. The automatic can be operated manually

and both types can be inflated orally by the tube. The oral tube is used to deflate the lifejacket. N.B! After gas inflation the lifejacket must be rearmed. Inside the lifejacket you will find instructions as to which rearming kit to use. Instructions to complete the rearming procedure are included with our rearming kits.

**Baltic inflatable lifejacket deflated**



**Baltic inflatable lifejacket inflated**



## GAS CYLINDER RETAINER

All Baltic lifejackets are fitted with a cylinder retainer to prevent the cylinder from working loose.

# ANNUAL INSPECTION

### The importance of annual inspection!

Inflatable lifejackets require inspection regardless of whether they have been inflated or not. A pre-wear check can be done by following the instructions on the next page. Failure to carry out the annual inspection may cause your inflatable lifejacket to malfunction! The annual inspection is best carried out by our accredited service

stations, or as an alternative you can perform a simplified inspection yourself. Refer to page 4 in this information brochure for instructions. Information of our accredited service stations are to be found on our web page: [www.baltic.se](http://www.baltic.se)

# PRE-WEAR CHECK

**Every time you wear your inflatable lifejacket you should check the following:**

## 1. Check the gas cylinder

Unscrew the gas cylinder anti clockwise and make sure it is not pierced. Screw the unpierced gas cylinder back tightly by hand clockwise. A pierced gas cylinder is empty and must be replaced.



## 2. Check the safety indicators and cartridge/capsule

### Automatic version:

Check both safety indicators. If either of the green indicators is missing and/or the gas cylinder is pierced the lifejacket must be rearmed. Carefully follow the instructions on the next page or the instructions enclosed with our rearming kits.

Check that the cartridge/bobbin is in date. See page 6.

### Manual version:

Check the safety indicator. If it is missing, the gas cylinder is empty and must be replaced. Carefully follow the instructions enclosed with our rearming kits.

The safety indicators do not indicate the replacement/expiration date on the cartridge/capsule.



UML-5 automatic valve



Mini Manual, manual valve



Pro Sensor MK2 automatic valve



Pro Sensor MK2 manual valve

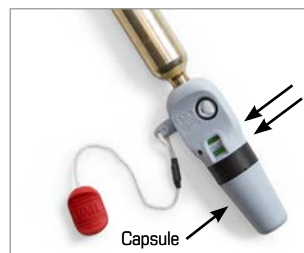

Pro Sensor Elite automatic valve



Pro Sensor Elite manual valve

## 3. Check pull knob

Check that the manual inflation pull knob is accessible when donned.



Pull cord

# ANNUAL SELF INSPECTION

Inflatable lifejackets demand regular inspections whether or not they have been used. Failure to carry out inspections may cause your lifejacket to malfunction. Follow the instructions below to perform a simplified annual self inspection. We recommend that you have one of our accredited service stations complete an enhanced certified annual inspection. For further information of our accredited service stations please visit our website: [www.baltic.se](http://www.baltic.se)

<p><b>1</b></p>	<p><b>2</b></p>	<p><b>3</b></p>
<p><b>4</b></p>	<p><b>5</b></p>	<p><b>6</b></p>
<p><b>7</b></p>	<p><b>8</b></p>	
<p><b>9</b></p>	<p><b>10</b></p>	
<p><b>11</b></p>	<p><b>12</b></p> <p>Check expiration date on cartridge/capsule.</p> <p><b>13</b></p> <p>Repack the lifejacket by following the instructions on page 6-7.</p>	

# REARMING

If your lifejacket has inflated automatically you will need to replace the gas cylinder and the automatic cartridge/capsule. Unscrew the gas cylinder and cartridge/capsule. If your lifejacket has been inflated by the manual pull cord only the gas cylinder may need replacing and a green clip will need to be placed over the manual lever. On a valve with indicator window where the indicator shows red the gas cylinder must be replaced and the manual lever fold back into the position

where you can hear a click sound. Mount a new cartridge/capsule, check the replacement date isn't expired, install a new gas cylinder, check it is not pierced before installation. Use only hand force when assembling the parts. If your lifejacket is equipped with a Pro Sensor MK2/Pro Sensor Elite valve both indicator windows must show green when new gas cylinder and cartridge/capsule is fitted.

## UML-5 automatic

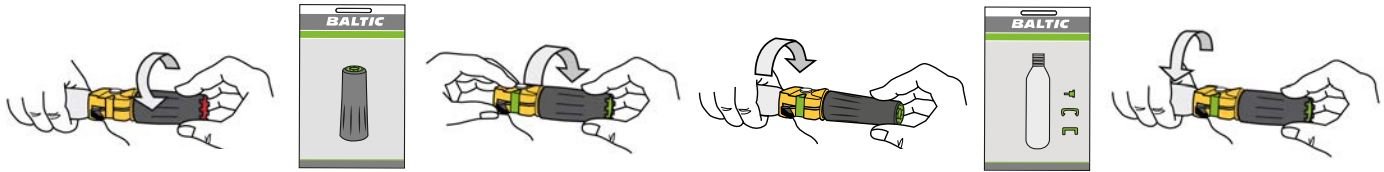

## Pro Sensor MK2 automatic

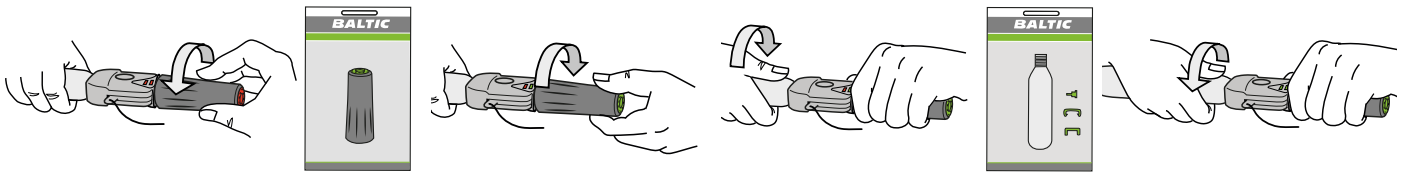

## Pro Sensor MK2 manual



## Pro Sensor Elite automatic

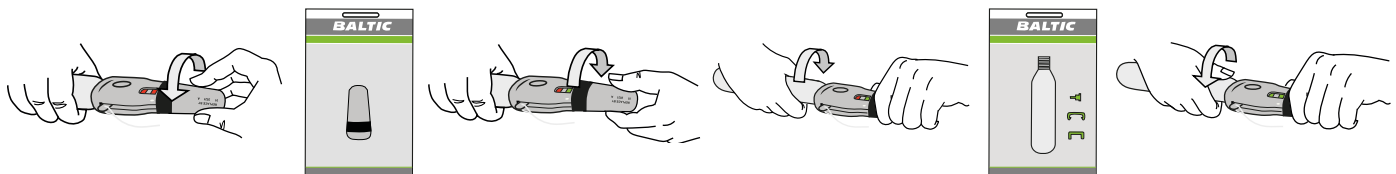

## Pro Sensor Elite manual

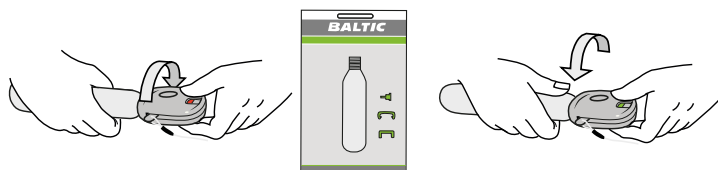

# CONTROL OF CARTRIDGE/CAPSULE/BOBBIN, DEFLATION AND REPACKING.

## United Moulders

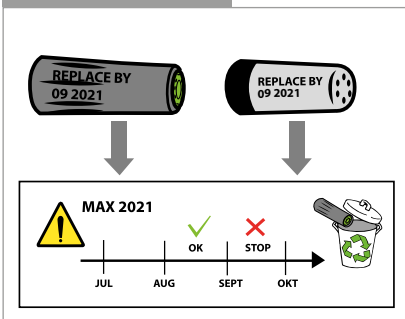

### United Moulders cartridge/capsule

On United Moulders cartridge/capsule Replace by month and year is printed. E.G. **092021** which means it must be replaced latest September 2021.

## Halkey Roberts

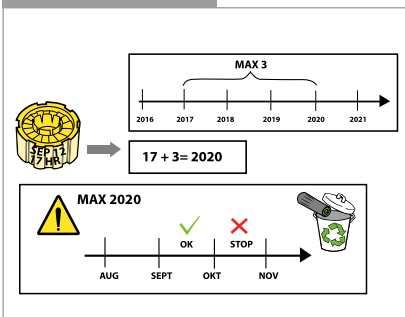

### Halkey Roberts bobbin

On Halkey Roberts bobbins the production month/day and year is printed. The bobbin has a life span of a maximum 4 years. In recreational use the bobbin must be replaced no later than the third year from its first use. For industrial use please refer to your agent or service station.

## Deflation of an inflated lifejacket

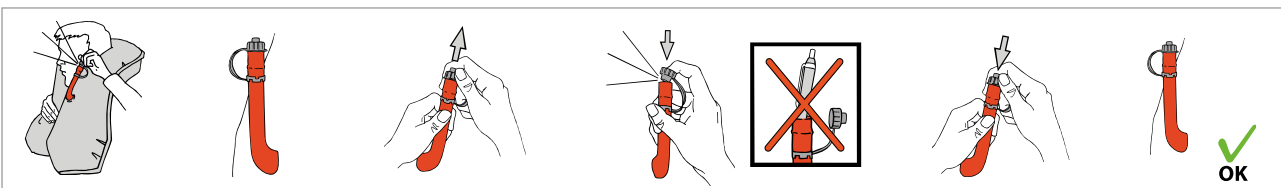

## Repacking of deflated and rearmed lifejacket (example of two different bladders)

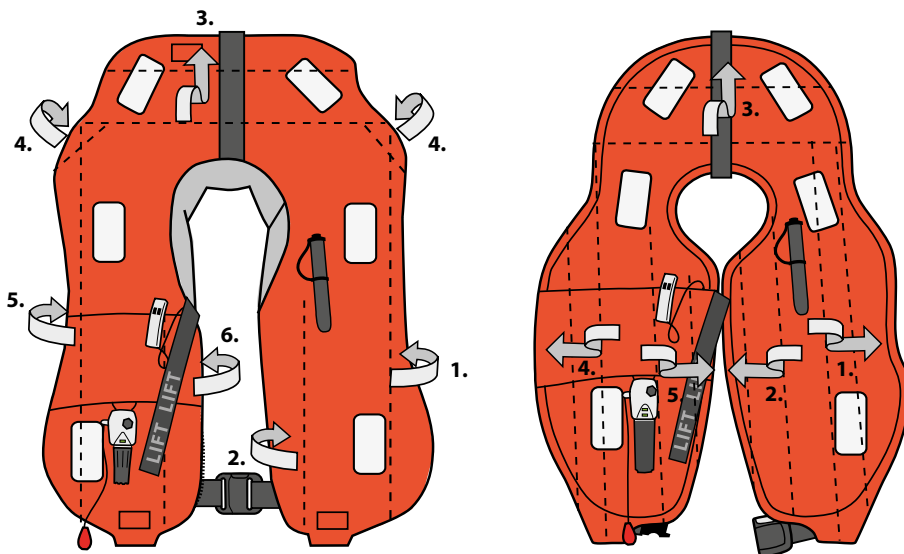

## Baltic burst zip - how to reclose



1. Pull the zip over the first stop (A) so the slider only is attached to the "under-side" of the zip.

2. Run the slider around the lifejacket, still on the "under-side" of the cover all the way to (B).

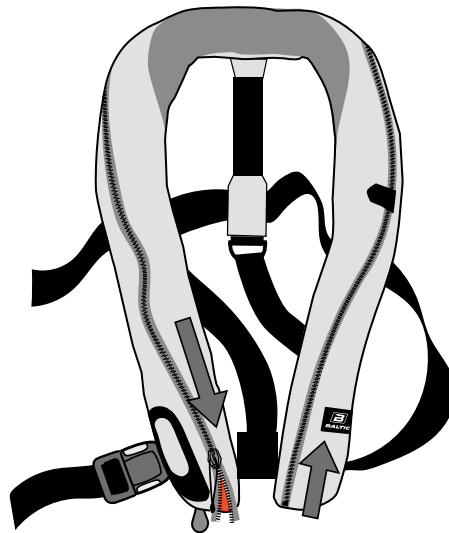

3. Fasten the slider to the zip as on a normal zip and pull the slider around the lifejacket to close it.

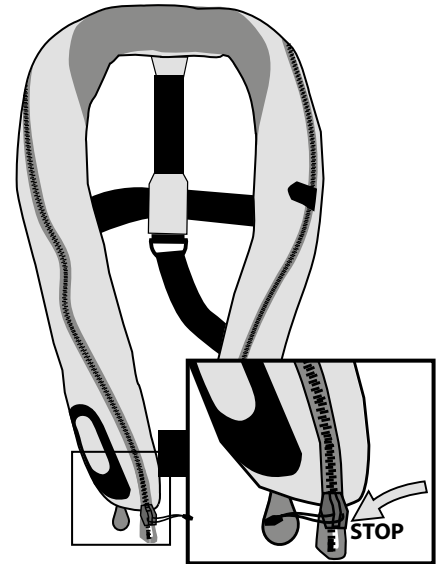

4. When the lifejacket is closed, make sure you stop the slider at the first stop. N.B. Do not pull the slider past the first stop! Fold over Velcro straps. Put the zip end into the cover.

## SPARE PARTS FOR REARMING

For maximum safety ensure only to fit genuine Baltic spares. The parts and kits listed below are available from our stockists and service stations. Our service stations are listed on our web site: [www.baltic.se](http://www.baltic.se)



**10 g cylinder**  
with safety indicators  
ART NO 2410



**16 g cylinder**  
with safety indicators  
ART NO 2416



**20 g cylinder**  
with safety indicators  
ART NO 2420



**33 g cylinder**  
with safety indicators  
ART NO 2433



**38 g cylinder**  
with safety indicators  
ART NR 2438



**Safety indicators**  
United Moulders,  
Halkey Roberts  
and Halkey Roberts Old.  
ART NO 2404



**Bobbin**  
Bobbin is stamped with production month and year. Refer to page 6.  
ART NR 2406



**Cartridge**  
Cartridge is stamped with replacement month and year. Refer to page 6.  
ART NR 2520



**Capsule**  
Capsule is stamped with replacement month and year. Refer to page 6.  
ART NR 2407

**BALTIC**<sup>®</sup>  
LIFEJACKETS SWEDEN

**United Kingdom office** Baltic Safety Products Uk Ltd • 7 Compass Point • Ensign Way Hamble • Southampton • SO31 4RA  
Tel +44 2380 457 272 • Fax +44 2380 454 747 • sales@baltic-uk.com • www.baltic.

**Head office** Baltic Safety Products AB • Box 60, S-545 02 ÄLGARÅS, SWEDEN  
Tel +46 506 369 90 • Fax +46 506 401 96 • info@baltic.se • www.baltic.se



**ISO 9001 Certified**  
Manufacturer of **M.E.D./SOLAS**  
approved products

